



First to market- Patent pending

Submittal Data Sheet SD113	EFFECTIVE 4/15/19
---	------------------------------



SUBMITTAL DATA APPROVAL

For: _____

Job: _____

Date Submitted: _____ By: _____

Date Approved: _____ By: _____

Model Number: _____ Quantity: _____

Model Number: _____ Quantity: _____

Model Number: _____ Quantity: _____

Model Number: _____ Quantity: _____



Aqua-Shield™ AMR-SFV1AXLT1 & AM7-SUV1AXLT1

Outdoor Circulator with Control Box

The AMR-SFV1AXLT1 flanged & AM7-SUV1AXLT1 union circulator with outdoor control box is designed for the recirculation of domestic hot water on systems with externally mounted tankless hot water heaters. The circulator is supplied with both a built-in timer and a built in Aquastat to minimize heat loss from the hot supply and hot water return lines. A built-in check valve stops hot water from flowing to the point of use via the return line. A standard grounded 115V cord and plug allows the circulator to be plugged into a standard 115V grounded receptacle. The circulator is freeze protected. Freeze protection starts the circulator to the normal operation when the temperature raises. The circulator is intended to be installed outdoors against a structure with the control box cover facing up. Tabs are included on both the control box cover and base that allow the box cover to be secured against rain, wind and tampering. Filters protect the control from insects & bugs.

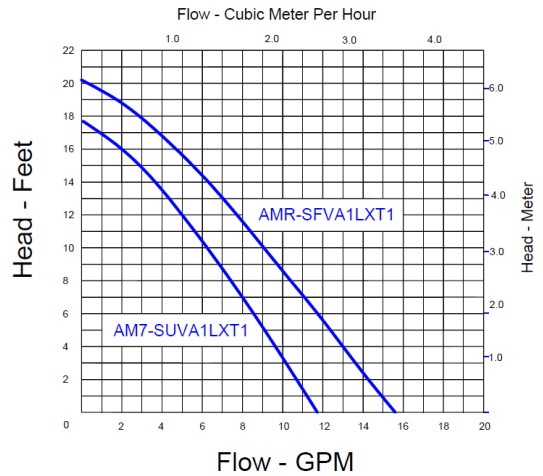

Materials of Construction

- Pump housing (volute).....Stainless Steel
- Motor housing.....Powder Coated Steel
- Outdoor Box..... Composite
- Seals & Gaskets.....Silicone & EPDM Rubber
- Internal Wetted Components.....Stainless Steel & Ceramic
- Bearings.....Carbon Impregnated Brass

AMR-SFV1AXLT1

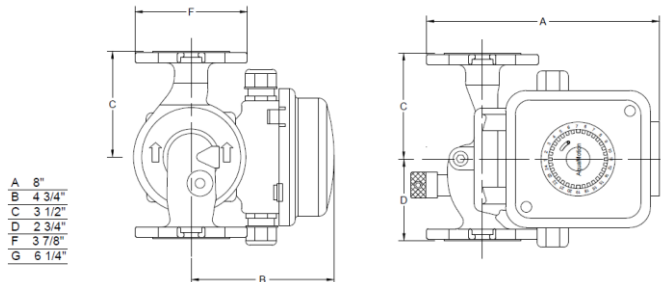

A	8"
B	4 3/4"
C	3 1/2"
D	2 3/4"
F	3 7/8"
G	6 1/4"

AM7-SUV1AXLT1

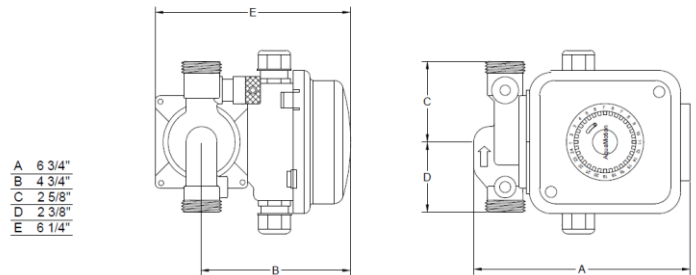

A	6 3/4"
B	4 3/4"
C	2 5/8"
D	2 3/8"
E	6 1/4"

Specifications

- Maximum Shut-off Head: AMR- SFV1AXLT1 20 feet
AM7-SUV1AXLT1 11feet
- Maximum Flow: AMR-SFV1AXLT1 16 gpm
AM7-SUV1AXLT1 12 gpm
- Maximum Operating Pressure: 125 psi
- Maximum Ambient Temperature: 104°F
- Minimum Inlet Pressure: 2 psi
- Maximum Water Temp: 230°F (110°C)
- Electrical Rating: 120V, 60Hz, .79A
- Aquastat setting 100° – 115°F
- 10 Foot Line Cord with grounded plug

US DESIGN • US BUILT