

INTRODUCTION

Thank you for choosing the AquaMotion On-Demand™ wireless remote transmitter and receiver kit. The remote transmitter and receiver allows you to wirelessly turn on/off connected AquaMotion circulators.

The receiver can communicate with up to 5 transmitters, so user has the option to add more, such as more remote controls, motion sensors, or wall switches.

KIT INCLUDES

- (1) Plug-In On/Off Receiver
- (1) Plug-In On/Off Receiver Antenna
- (1) Battery CR-2032 (Installed)
- (1) Instruction and Warranty Sheet
- (1) Transmitter Remote with remote holder and wall mount fasteners (May vary in appearance)

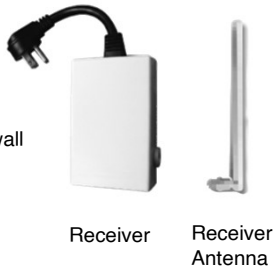

NOTE: The receiver is programmed to button #1 only at the factory when purchased as AMK-WB. No additional programming is required. If additional receivers are purchased, programming is required.

RECEIVER SETUP

1. Insert the antenna to the plug-in receiver as shown.
2. Place the antenna in the upright position for best reception.
3. Plug the receiver into an electrical outlet.
4. Plug in the circulator to the outlet on the receiver.

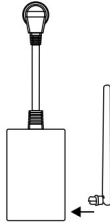

REMOTE TRANSMITTER SETUP

1. Remove the battery isolator from the remote transmitter. The red LED will flash once.
2. Press the button on the transmitter. The red LED should flash. If the red LED does not flash, refer to section "BATTERY" of this document.

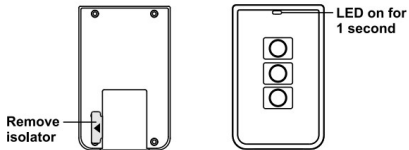

(Remote Transmitter (May vary in appearance))

PROGRAMMING THE TRANSMITTER TO RECEIVER

The transmitter (remote) is pre-programmed at the factory to button #1 for a 5 minute countdown period. Refer to section "TIMER DURATION" for programming the transmitter (remote) for a longer countdown period.

NOTE: You must complete the programming sequence within 15 seconds, otherwise, the receiver will quit from programming mode (red LED is off) and you will need to start again from step 3.

1. Plug in the receiver to an 110-120V AC electrical outlet. The red LED flashes once quickly.
2. Press and hold the "SET" button located on the receiver for about 10 seconds until the red LED is on steadily. Release the button when the red LED is solid red.
3. Use a small point object to press the red "PROG" button on the back of the transmitter (remote). The red LED will be solid red for about 15 seconds.
4. Press a button on the front of the transmitter (remote) that you plan to use.
5. The red LED on the transmitter (remote) will flash quickly then go off.
6. The red LED on the receiver will go out once the programming of the transmitter (remote) was successful.
7. Your transmitter (remote) and receiver is ready to be used now.

PROGRAMMING THE TRANSMITTER TO RECEIVER (cont.)

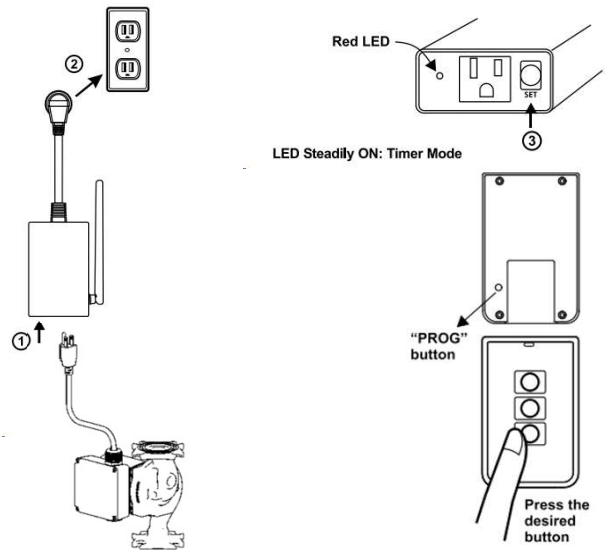

NOTE: The transmitter (remote) must be within 100 feet [30.5 m] of each other and in an open area when programming, 500 feet [152.4 m].

TIMER DURATION

The countdown period can be programmed to the following durations, meaning the red LED on the receiver will stay on for the following time: 5 minutes, 15 minutes, 30 minutes, or 60 minutes. Only one interval can be set per receiver.

1. Plug in the receiver to an 110-120V AC electrical outlet. The red LED on the receiver flashes once quickly.
2. Press the button on the transmitter (remote). The red LED on the receiver will be solid red. The LED must be on for time duration to be set.
3. Press and hold the "SET" button located on the receiver and in about 3 seconds the red LED flashes once.
4. Continue to hold the "SET" button until the number of flashes match the indicated duration listed below.

Number of Flashes	Timer Duration
2	5 min.
3	15 min.
4	30 min.
5	60 min.

NOTE: There is a 6 second delay between each number of flashes

BATTERY

If the operating range is reduced, or if the red LED does not flash during operation, it is time to replace the battery.

The transmitter (remote) is powered by a 3-volt coin-cell lithium battery CR2032 commonly used in automobile key fobs, watches, computers, etc.

Follow the instructions below to replace the battery in the transmitter (remote).

1. Slide out the battery door located on the back of the transmitter (remote).
2. Remove the old battery from the holder and then insert the new battery with the positive (+) side facing up.
3. Slide in the battery door to the transmitter (remote). The red LED on the front of the transmitter (remote) will be on for 1 second.

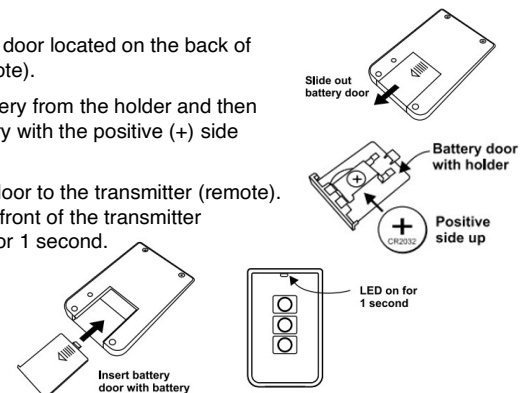

WARNING: Coin-cell batteries are a severe ingestion risk for young children and pets. Keep these batteries out of the reach of children and pets.

WARNING: DO NOT throw away batteries in the regular trash. Dispose of used batteries by a local hazardous waste collection point.

TECHNICAL SPECIFICATIONS

Input Voltage: 120V AC, 60Hz
Standby Current: 3mA
Minimum Power: 10W
Maximum Rating: 15A
Maximum Power: 1500W at 120V AC
Operating Frequency: 318 MHz
Temperature Rating: -4°F to 140°F [-20°C to 60°C]
Humidity: 5% to 95%
Range: Up to 500 feet in open area



FCC COMPLIANCE STATEMENT

This device complies with part 15 of the FCC Rules. Operation is subject to the following two conditions: (1) this device may not cause harmful interference, and (2) this device must accept any interference received, including interference that may cause undesired operation.

NOTE: This equipment has been tested and found to comply with the limits for a Class B digital device, pursuant to part 15 of the FCC Rules. These limits are designed to provide reasonable protection against harmful interference in a residential installation.

This equipment generates, uses, and can radiate radio frequency energy and, if not installed and used in accordance with the instructions, may cause harmful interference to radio communications. However, there is no guarantee that interference will not occur in a particular installation.

If this equipment does cause harmful interference to radio or television reception, which can be determined by turning the equipment off and on, the user is encouraged to try to correct the interference by one or more of the following measures:

- Reorient or relocate the receiving antenna.
- Increase the separation between the equipment and receiver.
- Connect the equipment to an outlet on a circuit different from that to which the receiver is connected.
- Consult the dealer or an experienced radio/TV technician for help.

Changes or modifications to this product not authorized by AquaMotion Inc. could void the electromagnetic compatibility (EMC) and wireless compliance and negate your authority to operate the product.

This product has demonstrated EMC compliance under conditions that included the use of compliant peripheral devices and shielded cables between system components. It is important that you use compliant peripheral devices and shielded cables between system components to reduce the possibility of causing interference to radios, television sets, and other electronic devices.

Exposure to radio frequency energy. The radiated output power of this device meets the limits of FCC/IC radio frequency exposure limits. This device should be operated with a minimum separation distance of 20 cm (8 inches) between the equipment and a person's body.

ICC COMPLIANCE STATEMENT

This device complies with Industry Canada license-exempt RSS standard(s). Operation is subject to the following two conditions: (1) this device may not cause interference, and (2) this device must accept any interference, including interference that may cause undesired operation of the device.

AQUAMOTION LIMITED WARRANTY STATEMENT

AquaMotion Inc. warrants its product to the original user against defects in material and workmanship for a period of one (1) year from date of original shipment. Complete pump warranty is three (3) years from date of shipment. Valves, timers, On Demand devices and receivers carry a one (1) year warranty from date of shipment. Aqua-Max Pressure Booster warranty is one (1) year from date of shipment. In the event of a defect within the warranty period, AquaMotion Inc. will, at its option, replace or recondition the product without charge, FOB AquaMotion factory. This shall constitute the exclusive remedy for breach of warranty, and AquaMotion Inc. shall not be responsible for any cost of removal, installation, transportation or any charges which arise in connection with the warranty claims and shall not be responsible for any incidental or consequential damages, including without limitation, damages or other cost resulting from labor charges, delays, or vandalism, negligence, fouling caused by foreign materials, damage from adverse water conditions, freezing, chemicals, certain additives, petroleum-based fluids, or any other circumstances over which AquaMotion Inc. has no control. This warranty shall be invalidated by any abuse, misuse, misapplication or improper installation or maintenance of the product. AquaMotion Inc. makes no other warranties express or implied except as provided in this limited warranty. Consult the product instruction sheets for proper use and installation. Contact the factory with any questions. To obtain service under this warranty, the defective product must be returned to the distributor or dealer of AquaMotion products from which it was purchased together with proof of purchase, installation date, and supporting installation data. Unless otherwise provided, the distributor or dealer will contact AquaMotion Inc. or an authorized service station for instructions. Any defective product to be returned to AquaMotion Inc. or an authorized service station shall be sent freight prepaid; documentation supporting the warranty claim and/or Return Material Authorization must be included, if so instructed.

AQUAMOTION INC. WILL NOT BE LIABLE FOR ANY INCIDENTAL OR CONSEQUENTIAL DAMAGES, LOSSES, OR EXPENSES ARISING FROM INSTALLATION, USE, OR ANY OTHER CASES. THERE ARE NOT EXPRESS OR IMPLIED WARRANTIES, INCLUDING MERCHANTABILITY OR FITNESS FOR A PARTICULAR PURPOSE, WHICH EXTEND BEYOND THOSE WARRANTIES DESCRIBED OR REFERRED TO ABOVE.

AQUAMOTION PRODUCT CHANGE STATEMENT

AquaMotion Inc. reserves the right to change or modify product design or construction without prior notice and without incurring any obligations to make such changes and modifications on products previously or subsequently sold. AquaMotion Inc. shall have no responsibility whatsoever with respect to changes made by the manufacturer in products or their packaging sold but not manufactured by AquaMotion Inc. This warranty gives the purchaser specific rights, and the purchaser may have other rights which vary from State to State. Some states do not allow limitations on how long an implied warranty lasts or on the exclusion of incidental or consequential damages, therefore, these limitations or exclusions may not apply.

AQUAMOTION CUSTOMER SUPPORT

AquaMotion, Inc.
88C Jefferson Blvd. Warwick, RI 02888
(401) 785-3000
info@AquaMotionHVAC.com
www.AquaMotionHVAC.com

 **WARNING: Cancer and Reproductive Harm - www.P65Warnings.ca.gov**